

# LC 3/8 " series - Sample Cooler

**LECOL** LC series provide the most efficient cooling process. This unique design is suitable for most water and steam sampling applications. The unique helical coil design combined with the shell and tube structure achieves high-efficiency heat exchange and maximizes the cooling ability. Multiple tube sizes and lengths offer to conduct different scenarios and solve any possible sampling problem.

Our unique Dual Helical Coil design by seamless non-welded joints can provide an extensive heat exchange area for different applications, less maintain operation and prevent any potential leakage while strengthening safety and accuracy.



(5" shell)

(4" shell)

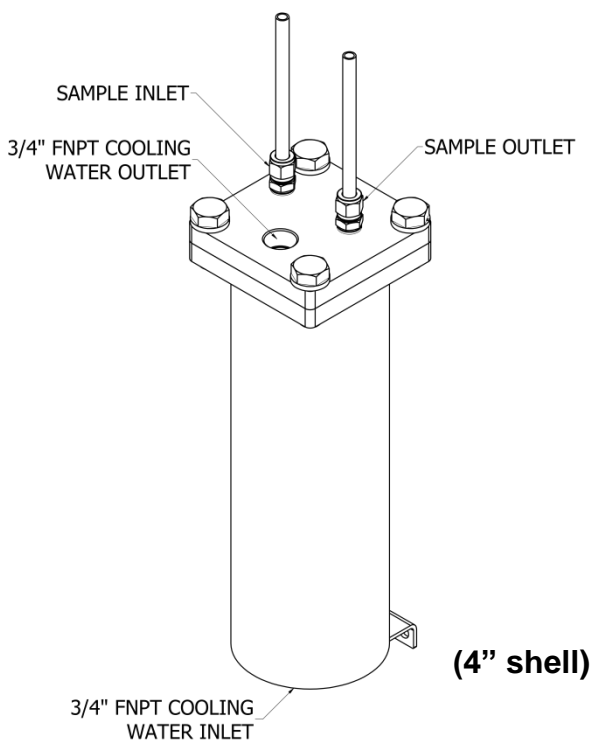

## Features

- Standard 304 stainless steel body and inner tube are made by 316L seamless stainless steel providing a better corrosion resistance and longer lifespan.  
\*optional body material 316SS\*
- Unique dual helical coil design provides an extensive heat exchange area up to 0.32 square meters to conduct numerous applications.
- Compact design minimizes cooling water needs
- The removable shell design leads can maintenance easily and cleaning procedure.
- For boiler water analysis, steam, cooling applications, or other sampling.

**LECOL**

# Performance Curve LC-3/8 Series

3/8 in. Cooler -12M Tube

**For Steam**

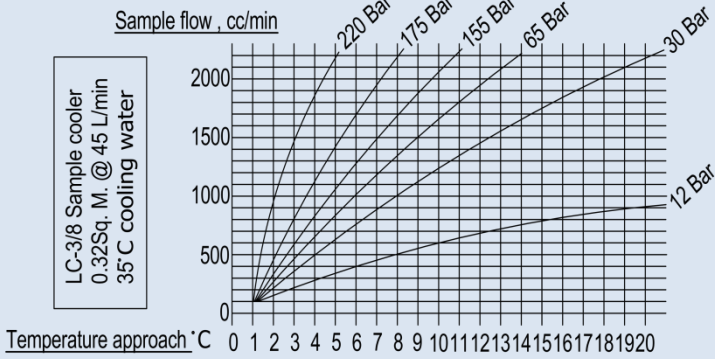

3/8 in. Cooler -12M Tube

**For Water**

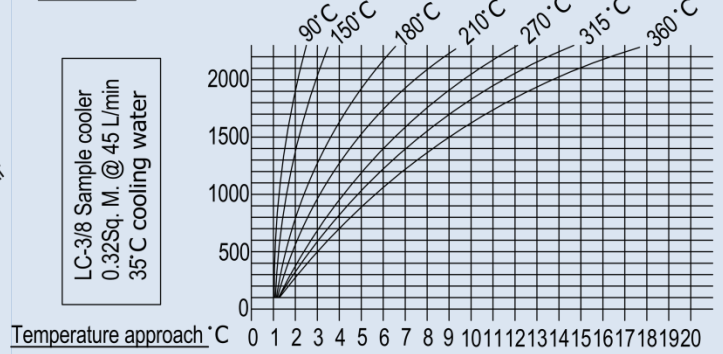

## Dimension (4" shell)

Model: LC-3/8-12-A-2  
LC-3/8-12-S-2

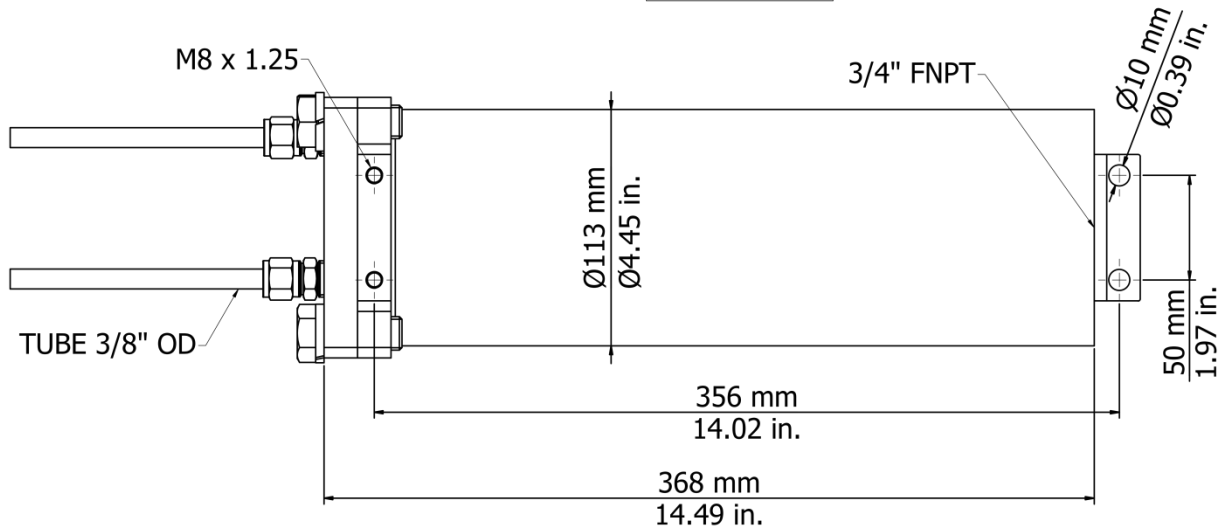
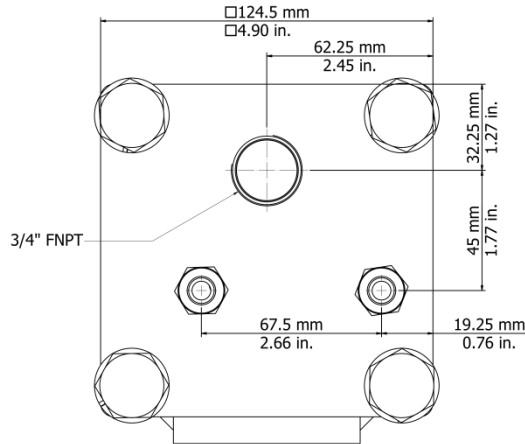

# Dimension (5" shell)

Model: LC-3/8-12-T-2

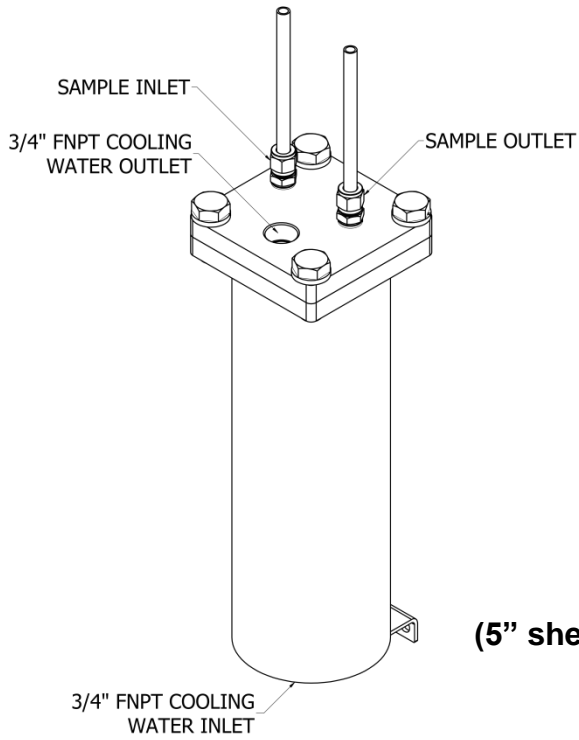

(5" shell)



(5" shell)

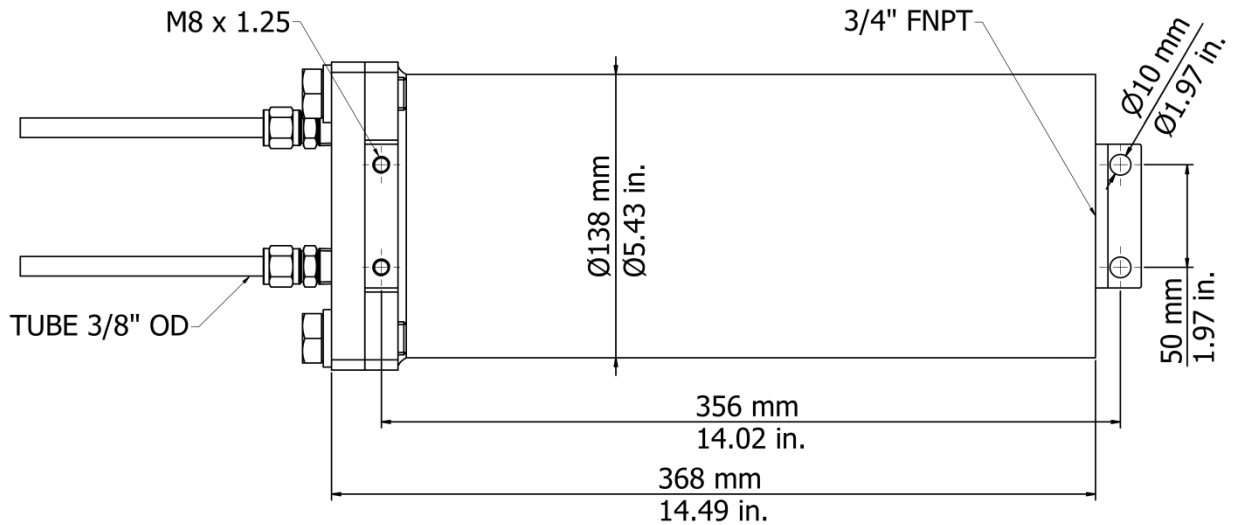
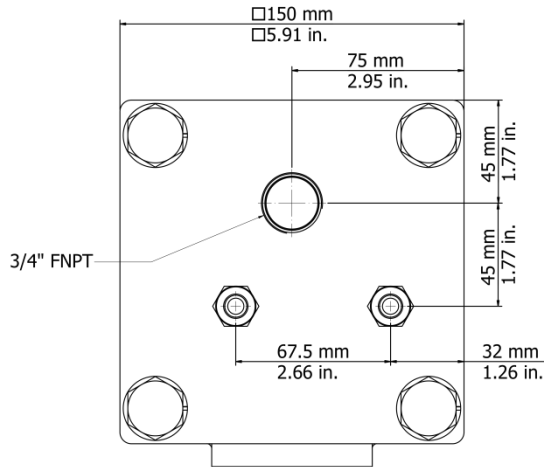

## Specification

Model	Tube material Size Rating	Shell material Rating	Shell Size	Cooling Area	Net Weight
LC-3/8-12-S-2-4	316L SS 3/8 in. OD X 0.65 in. T x 12M 345 bar @ 537°C	304 SS 25 bar @ 200°C	4 in. OD shell	0.32 Sq. M.	15 kg
LC-3/8-12-S-2-5	316L SS 3/8 in. OD X 0.65 in. T x 12M 345 bar @ 537°C	304 SS 25 bar @ 200°C	5 in. OD shell	0.32 Sq. M.	20 kg
LC-3/8-12-A-2-4	316L SS 3/8 in. OD X 0.65 in. T x 12M 345 bar @ 537°C	316 SS 25 bar @ 200°C	4 in. OD shell	0.32 Sq. M.	15 kg

\*LECOL reserve the right to make technical changes or modify the contents of this document without prior notice.



### Luh Cherng Enterprises co., Ltd.

No. 42, Mei-shan Rd., Niasong Dist., Kaohsiung

City 83346, Taiwan

TEL : +886 7 7336377 FAX : +886 7 7336353

E-mail : [sales@lecoltw.com](mailto:sales@lecoltw.com)

Website : [www.lecoltw.com](http://www.lecoltw.com)

